

# PL-66 Round Privacy Installation Diagram

(Minimum Door Thickness 1-3/8")

\*Note: Turnpiece & Emergency Release  
come pre-installed on Interior and Exterior  
Plate

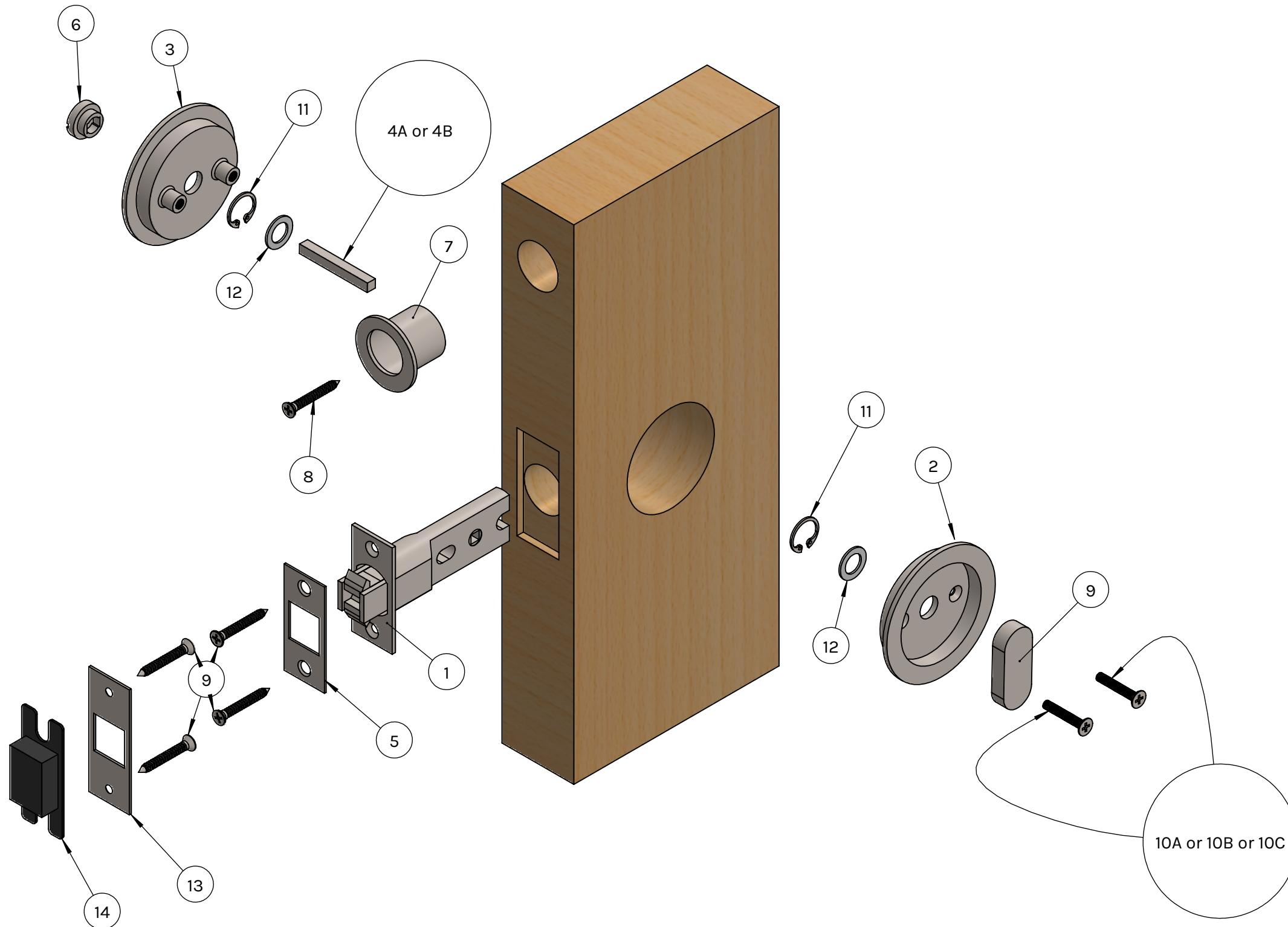

linnea-home.com  
(800) 219-2366

# Component List

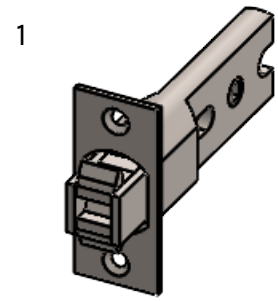

**Latch**  
PL-LAT66B-USS  
(Needs 1)

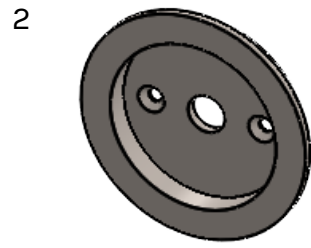

**Inside Trim**  
PLA66R-I  
(Needs 1)

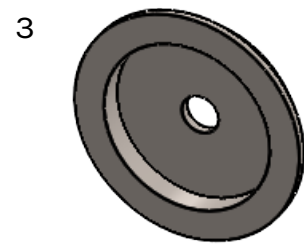

**Outside Trim**  
PLA66R-O  
(Needs 1)

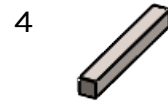

**Spindle**  
4A: PL-SPDL31  
4B: PL-SPDL36

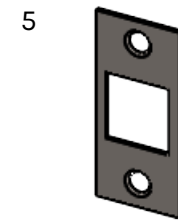

**Face Plate**  
PL-LAT66FP  
(Needs 1)



**Emergency Release**  
PL-KNER  
(Needs 1)

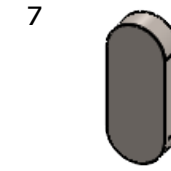

**Turn Piece**  
PL-KN66S  
(Needs 1)

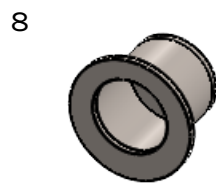

**Edge Pull**  
EP-400R  
(Needs 1)

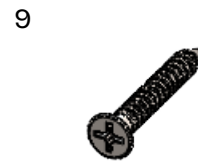

**Wood Screw**  
#8 X 3/4"  
(Needs 5)

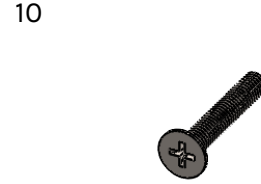

**Machine Screw**  
10A: SCR-M4FL20  
10B: SCR-M4FL23  
10C: SCR-M4FL28



**Snap Ring**  
PL-CCLIP11  
(Needs 2)



**Plastic Washer**  
PL-WAS12  
(Needs 2)

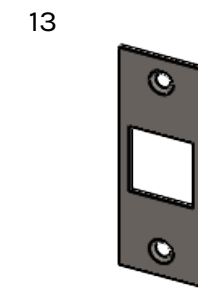

**Strike Plate**  
PL-LAT66STK  
(Needs 1)

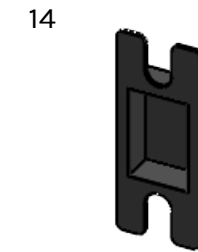

**Dust Box**  
(Needs 1)

